

- GENERAL NOTES:
- 1 RAIN BIRD ESP-SMTc
  - 2 INSIDE WALL MOUNT
  - 3 1-INCH PVC SCH 40 CONDUIT AND FITTINGS
  - 4 WIRES TO REMOTE CONTROL VALVES AND SENSOR
  - 5 STANDARD MODULE FOR 4-STATION CONTROLLER
  - 6 OPTIONAL MODULES FOR 22-STATION CONTROLLER
  - 7 100 VAC, 80 HZ EXTERNAL PLUG-IN TRANSFORMER
  - 8 CONNECTION FOR WIRES FROM SENSOR

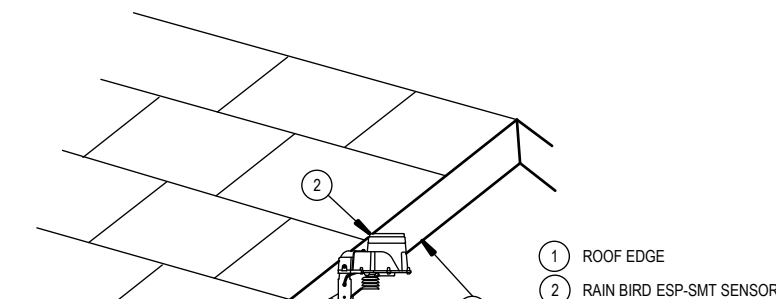

- NOTES:
- 1 LENGTH OF WIRE FROM CONTROLLER TO SENSOR SHOULD BE NO GREATER THAN 200 FEET
  - 2 SENSOR MAY BE MOUNTED ON FENCE, FENCE POST OR ON EAVE OF BUILDING
  - 3 SENSOR SHOULD NOT BE MOUNTED UNDER TREES, IN AREAS AFFECTED BY SPRINKLER SYSTEM OR UNDER EAVE OF BUILDING

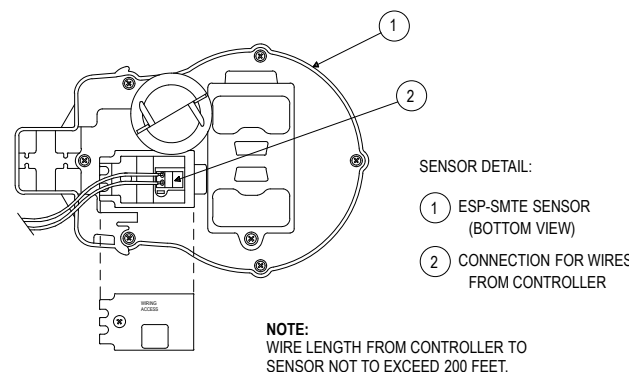
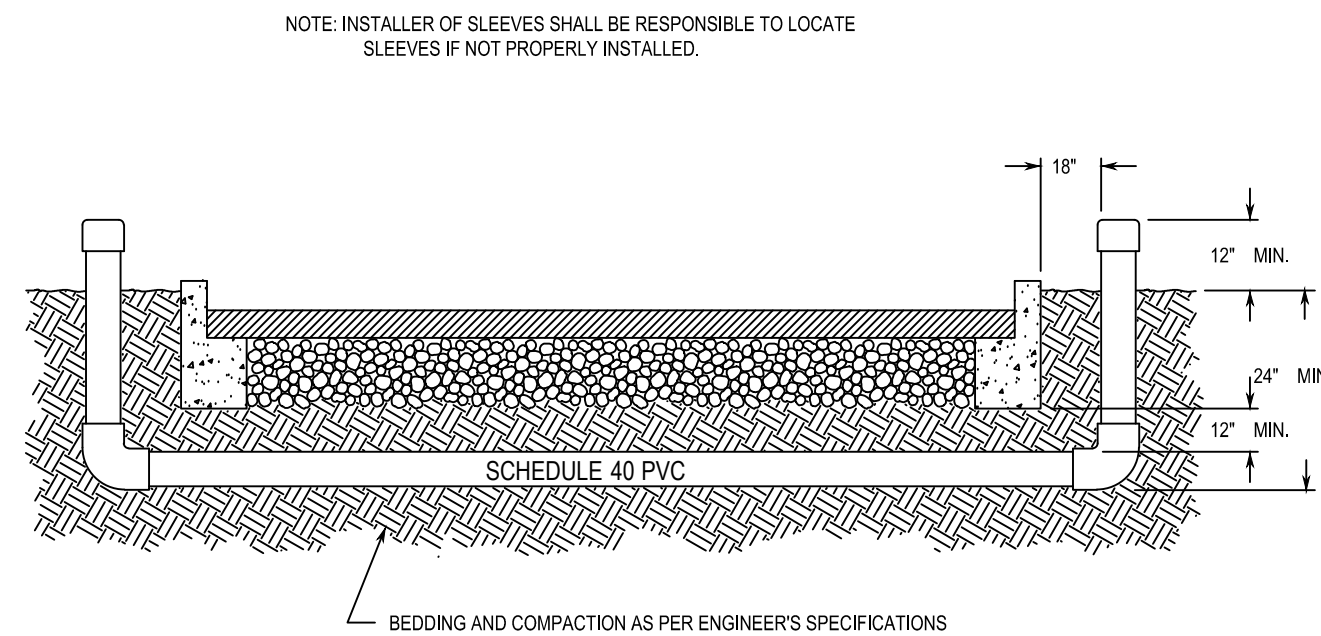
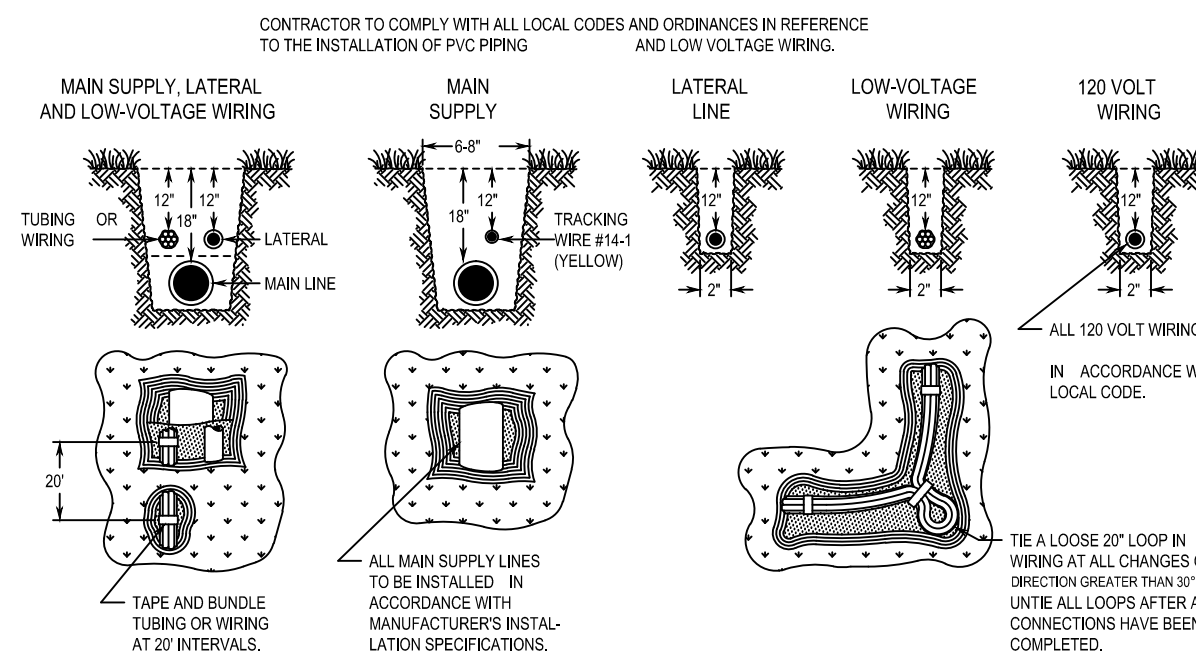

## 1 IRRIGATION SMART CONTROLLER: ESP-SMTc

SCALE:NTS

## 2 IRRIGATION WEATHER SENSOR

SCALE:NTS (LOCATE AT DUMBER WALL)

## 3 IRRIGATION TRENCHING AND PIPE DEPTH

SCALE:NTS

## 4 IRRIGATION SLEEVING

SCALE:NTS

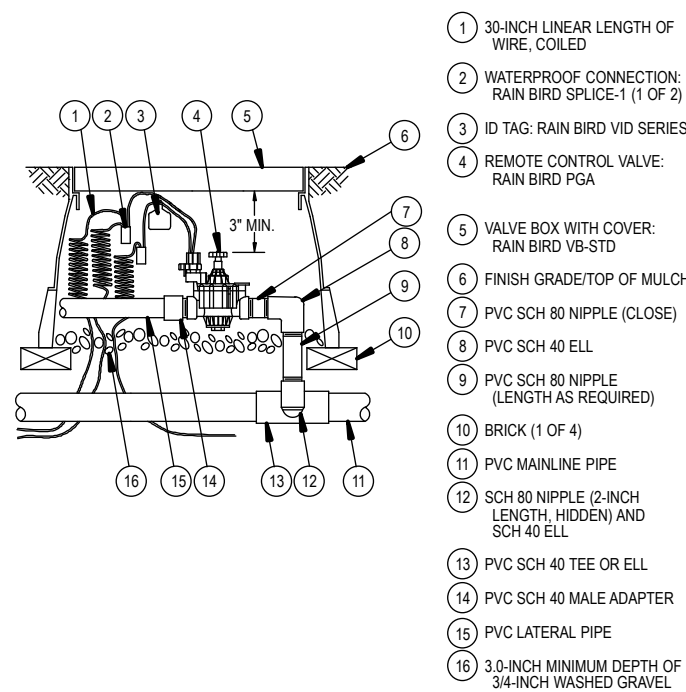

## 5 IRRIGATION VALVE: 100-PGA

SCALE:NTS

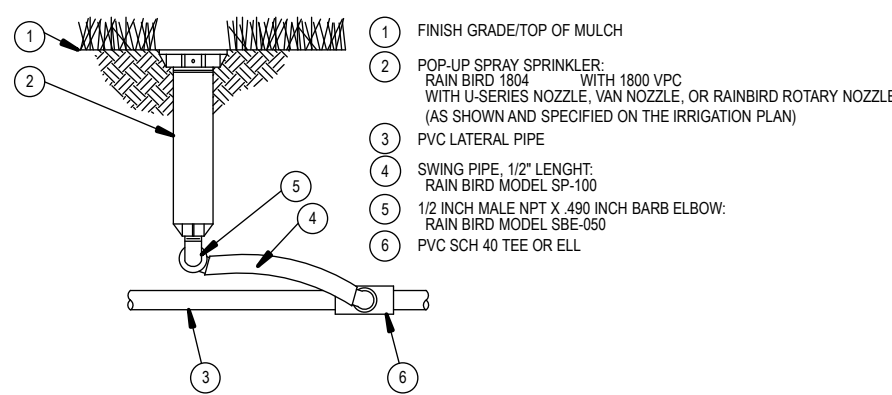

## 6 POP-UP SPRAY: 1804 SERIES

SCALE:NTS

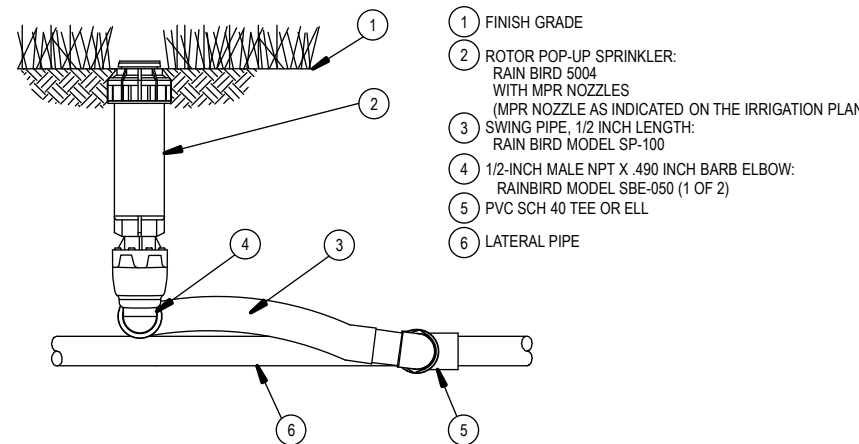

## 7 POP-UP ROTOR: 5004 SERIES W/T MPR NOZZLE

SCALE:NTS

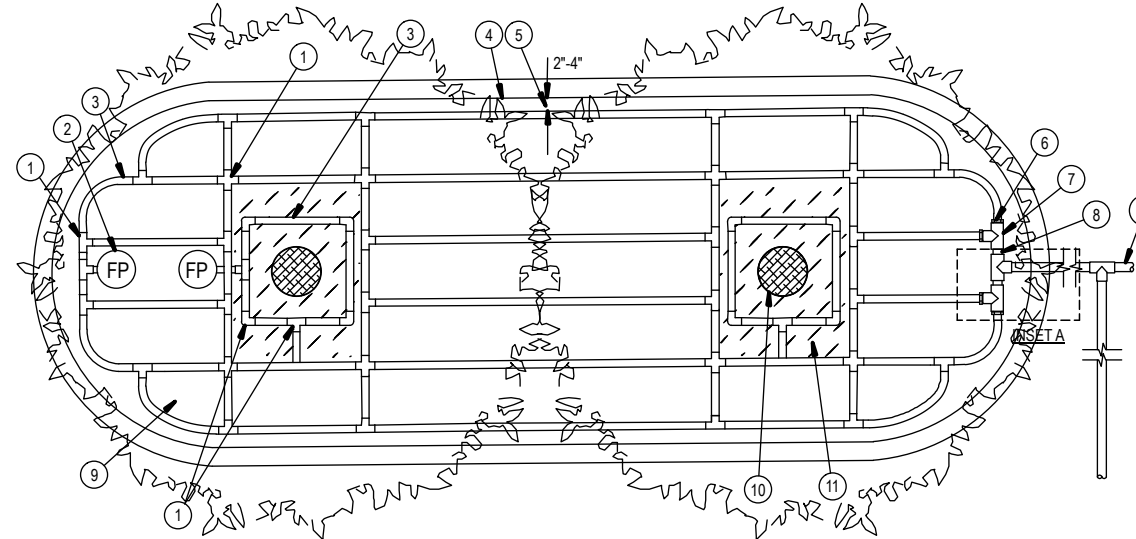

- NOTES:
- 1 DISTANCE BETWEEN LATERAL ROWS AND EMITTER SPACING TO BE BASED ON SOIL TYPE, PLANT MATERIALS AND CHANGES IN ELEVATION. SEE INSTALLATION SPECIFICATIONS ON RAIN BIRD WEB SITE (WWW.RAINBIRD.COM) FOR SUGGESTED SPACING.
  - 2 LENGTH OF LONGEST DRIP LATERAL SHOULD NOT EXCEED THE MAXIMUM SPACING SHOWN IN THE ACCOMPANYING TABLE.
  - 3 PLACE TIE DOWN STAKES EVERY THREE FEET IN SAND, FOUR FEET IN LOAM, AND FIVE FEET IN CLAY.
  - 4 AT FITTINGS WHERE THERE IS A CHANGE OF DIRECTION SUCH AS TEES OR ELBOWS, USE TIE-DOWN STAKES ON EACH LEG OF THE CHANGE OF DIRECTION.
  - 5 WHEN USING 17MM INSERT FITTINGS WITH DESIGN PRESSURE OVER 50PSI, IT IS RECOMMENDED THAT STAINLESS STEEL CLAMPS BE INSTALLED ON EACH FITTING.

Inlet Pressure psi	XPCV Drip Line Maximum Lateral Lengths (Feet)			
	10" Spacing	12" Spacing	15" Spacing	18" Spacing
20	152	136	104	75
30	200	176	136	104
40	250	224	176	136
50	300	272	216	164
60	350	320	256	192

- 1 BARB X BARB INSERT EL TEE OR CROSS
- 2 FLUSH POINT (TYPICAL)
- 3 ON-SURFACE DRIP LINE PIPE
- 4 PARKING ISLAND CURB
- 5 PERMETER DRIP LINE PIPE TO BE INSTALLED 2'-4" FROM PARKING ISLAND CURB
- 6 BARB X MALE FITTING
- 7 PVC SCH 40 TEE OR EL (TYPICAL)
- 8 PVC SUPPLY MANIFOLD
- 9 SHRUB OR GROUND COVER BED
- 10 TREE (TYPICAL)
- 11 MULCH BED FOR TREE
- 12 3-4 INCHES DEPTH OF MULCH
- 13 FINISH GRADE
- 14 PVC DRIP MANIFOLD FROM RAIN BIRD CONTROL ZONE VALVE KIT (SIZES TO MEET LATERAL FLOW DEMAND)
- 15 PVC RISER PIPE

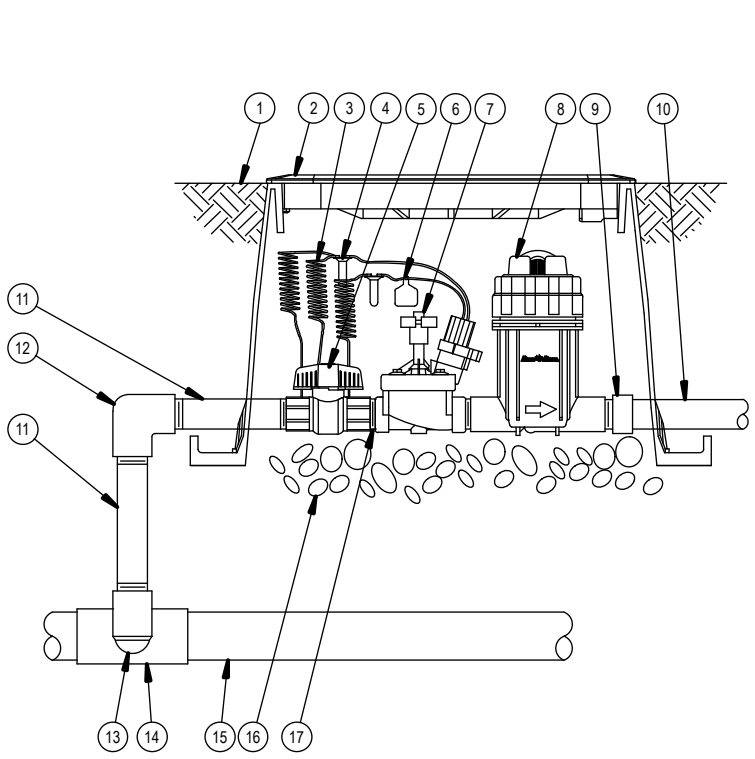

## 9 DRIP VALVE: XCZ-PRB-100-COM

SCALE:NTS

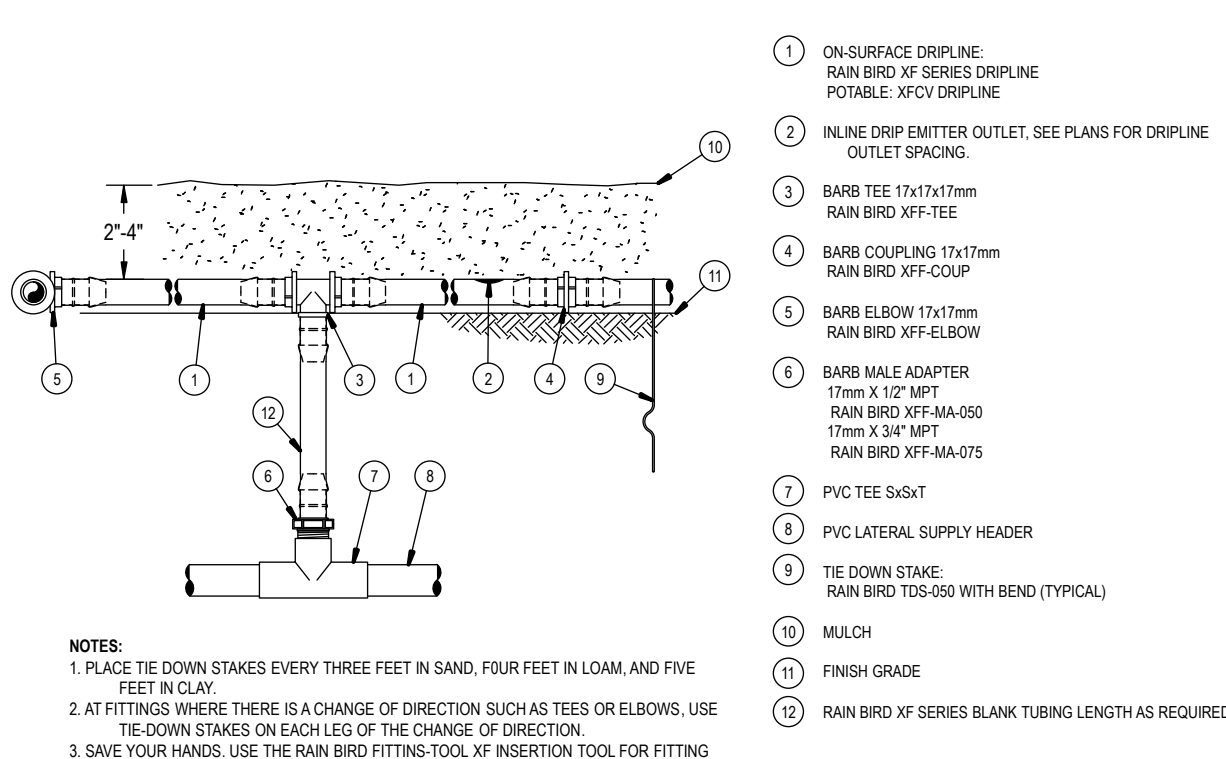

## 10 DRIP: ON-SURFACE RISER ASSEMBLY

SCALE:NTS

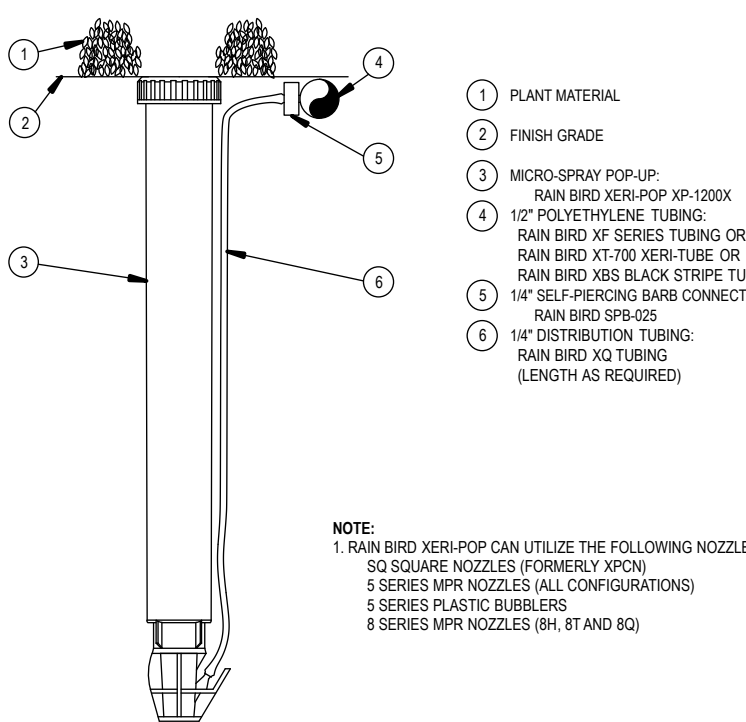

## 11 DRIP: XERI-POP MICRO SPRAY

SCALE:NTS (FOR USE AT COLOR BEDS)

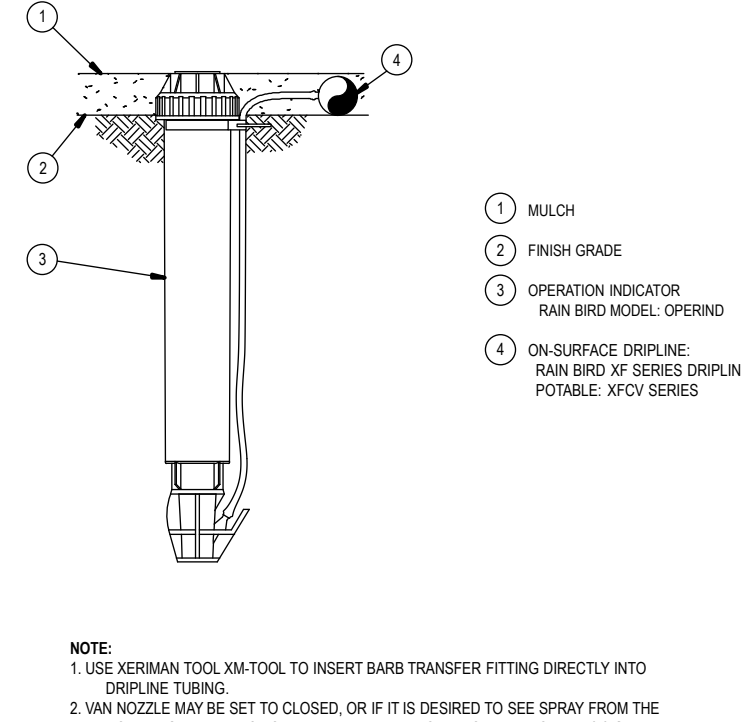

## 12 DRIP: PERATION INDICATOR

SCALE:NTS

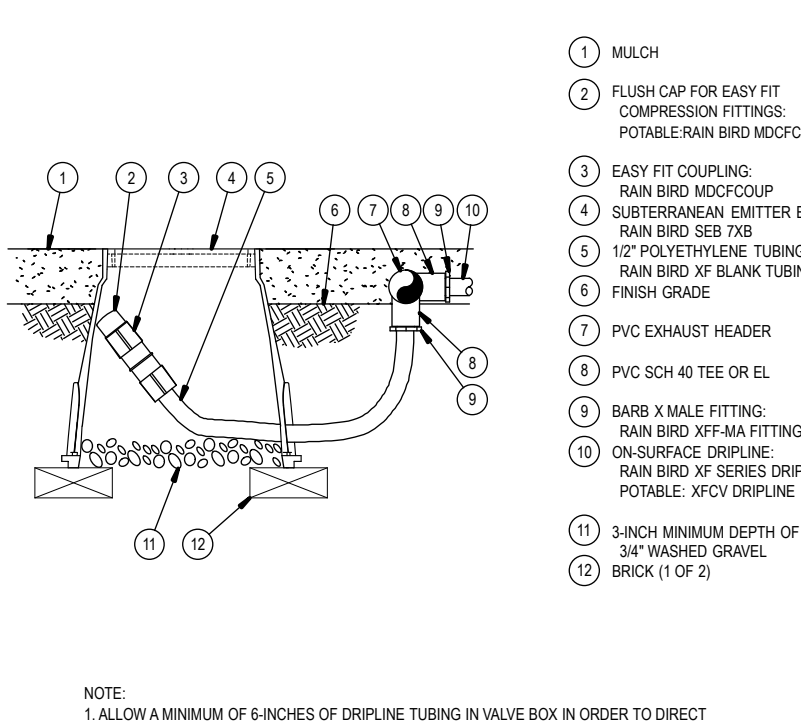

## 13 DRIP: DRIPLINE FLUSH POINT

SCALE:NTS



Chick-fil-A  
5200 Buffington Road  
Atlanta, Georgia  
30349-2998



770.442.8171 tel

770.442.1123 fax

Manley Land Design, Inc.  
51 Old Canton Street  
Alpharetta, Georgia 30009

manleylanddesign.com

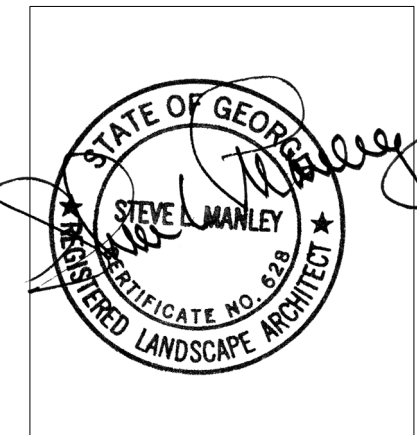

CHICK-FIL-A  
Jimmy Carter Boulevard  
5455 Jimmy Carter Boulevard  
Norcross, GA 30093

FSU# 0745

REVISION SCHEDULE

NO. DATE DESCRIPTION

MLD PROJECT # 2018003

PRINTED FOR Permit

DATE 1.10.18

DRAWN BY SLG

Information contained on this drawing and in all digital files produced for above named project may not be reproduced in any manner without express written or verbal consent from authorized project representatives.

SHEET

Permit Irrigation Details

SHEET NUMBER

L-201