

8193761 Thermal Cutoff (T.C.O.) SERVICE REPLACEMENT KIT

⚠ WARNING



Electrical Shock Hazard

**Disconnect power before servicing.
Replace all parts and panels before
operating.**

**Failure to do so can result in death
or electrical shock.**

Kit Contains:

- (1) Thermal Cutoff (T.C.O.)
- (1) Plastic Shield
- (1) Harness Assembly (includes terminal block)
- (2) Mini Zip Ties
- (1) Instruction Sheet

NOTE: The thermal cutoff (TCO) kit harness assembly has two yellow/black wires. When placing the dishwasher harness wires (black and black/white) into the terminal block of the kit harness assembly there is no need to match colors with the mating side of the terminal block. Hence the black wire will mate to one yellow/black wire and the black/white wire will mate to the other yellow/black wire.

7. Clip the new thermal cutoff (TCO) that's part of the kit onto the dishwasher control housing. See Figure 3 to confirm proper orientation of the mylar shield on the TCO.

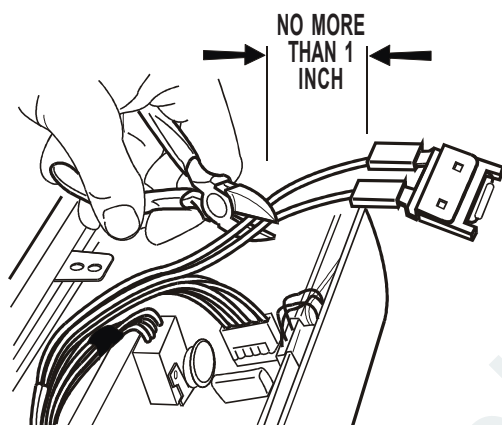

FIGURE 1

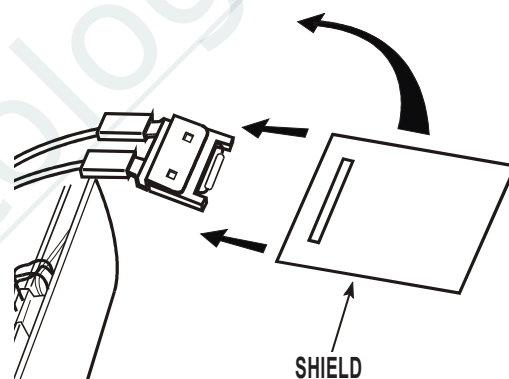

FIGURE 3

4. Remove defective T.C.O. from the control housing, using a flat blade of screwdriver to lift the snap.
5. Using wire strippers (set for 16-gauge wire), strip the two cut harness wires on the existing wiring harness approximately $\frac{1}{4}$ " (.64 cm) each and tightly twist the wire strands on the end of each wire.
6. Insert each stripped wire, one at a time, into the terminal block on the end of the TCO kit wiring assembly and tighten the screw securely. Tighten the screw using a small flat blade screwdriver. See Figure 2.

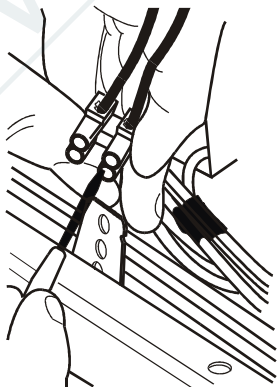

FIGURE 2

8. Using mini zip ties provided, secure wiring together, away from electrical components. See Figure 4.

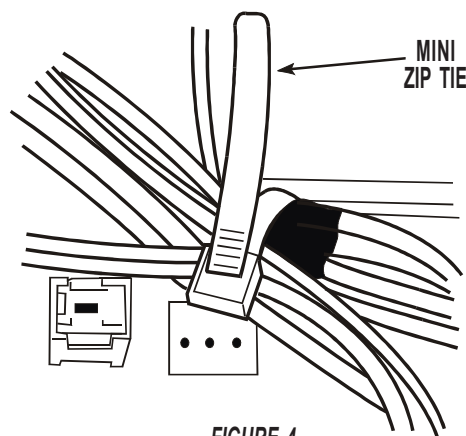

FIGURE 4

9. Fold control panel back, into position. Secure the control console to the inner door with the six (6) screws.
10. Reconnect power or plug in the dishwasher.
11. Ensure proper operation of the dishwasher.