

FINISH SCHEDULE					
ROOM NAME	FLOOR	BASE	WALL	CEILING	
(100) DINING ROOM	T200 24" X 24" TILE T402 INLAY	T111 TILE SIZE: REF. SCHEDULE T200 TILE SIZE: REF. SCHEDULE T124 FULL TILE	T111 TILE SIZE: REF. SCHEDULE T111, T124 G-1	T111 TILE T200 TILE C3 GYP BOARD W/ PAINT P103	03-06-22
(101) SERVING AREA	S1 PLAIN S2 ABRASIVE IN HIGH TRAFFIC AREAS	S1 6" H CONT. (KITCHEN EQUIPMENT ON 6" NSF APPROVED LEGS)	T111 HAND SINK WALL WP1 FRP PANEL	TILE C3 GYP BOARD W/ SMOOTH WASHABLE PAINT	
(103) KITCHEN	S1 PLAIN S2 ABRASIVE IN HIGH TRAFFIC AREAS	S1 6" H CONT. (KITCHEN EQUIPMENT ON 6" NSF APPROVED LEGS)	WP3 S.S. BEHIND COOK LINE WP1 FRP PANEL	C2 2' X 4' SUSPENDED GRID WASHABLE VINYL COATED GYP BOARD PANELS	
(104) KITCHEN PREP.	S1 PLAIN S2 ABRASIVE IN HIGH TRAFFIC AREAS	S1 6" H CONT. (KITCHEN EQUIPMENT ON 6" NSF APPROVED LEGS)	WP1 FRP PANEL	C2 2' X 4' SUSPENDED GRID WASHABLE VINYL COATED GYP BOARD PANELS	
(105) WALK-IN COOLER	S1 PLAIN S2 ABRASIVE IN HIGH TRAFFIC AREAS	S.S. / ALUMINUM WITH 3/8" RADIUS	EXT S.S.	ALUMINUM GALVANIZED STAINLESS STEEL	
(105A) WALK-IN FREEZER	S1 GALVANIZED STAINLESS STEEL S1 SILKAL UNDER WIF SUBFLOOR	S.S. / ALUMINUM WITH 3/8" RADIUS	EXT S.S. INT ALUMINUM GALVANIZED S.S.	ALUMINUM GALVANIZED STAINLESS STEEL	
(106) MEN'S ROOM	T200 24" X 24" TILE	T108 FULL TILE SCHLUTER	T108	TILE C3 GYP BOARD W/ P101 SMOOTH WASHABLE PAINT	
(107) WOMEN'S ROOM	T200 24" X 24" TILE	T108 FULL TILE SCHLUTER	T108	TILE C3 GYP BOARD W/ P101 SMOOTH WASHABLE PAINT	
(108) VESTIBULE	T200 24" X 24" TILE	T124 FULL TILE	P104 T124	C3 GYP BOARD W/ P101 SMOOTH WASHABLE PAINT	
(111) ENTRY VESTIBULE	T200 24" X 24" TILE M100 4' X 6' MAT	T124 FULL TILE	P104 T124	C3 GYP BOARD W/ P101 SMOOTH WASHABLE PAINT	

DOOR & HARDWARE SCHEDULE					
INSTALLED AND FURNISHED BY G.C. UNLESS NOTED OTHERWISE					
NO.	DESCRIPTION	HARDWARE	HINGE	STOP	ACCESSORIES

CONTRACTOR TO PURCHASE DOOR HARDWARE & FRAME DIRECTLY FROM PANDA'S NATIONAL ACCOUNT SUPPLIER. SUPPLIER TO PROVIDE ALL STOREFRONT DOOR HARDWARE, PLAM DOORS & FRAMES AND HM DOORS & FRAMES

CONTACT FOR QUOTING, ORDERING & LOGISTICS
APRIL WALDREN, PROJECT MANAGER
800-887-4307 EXT. 350 PHONE
AprilW@locknet.com, panda@locknet.com

NOTE!!! CONTRACTOR HAS THE OPTION TO PURCHASE STOREFRONT HARDWARE FROM OTHER SOURCE. PROVIDED THE HARDWARE IS PER SPECS. NO SUBSTITUTIONS ALLOWED. STOREFRONT HARDWARE SPECS ARE PROVIDED IN THE PROJECT BID PACKAGE. COORDINATE WITH PANDA PROJECT MANAGER LISTED ON SHEET G-001

ADDITIONAL CONTACTS:
THOMAS DOWNS, SALES MANAGER; ThomasD@locknet.com; 800-887-4307 x116
EDDIE ANDUEZA, DIR. ARCH. DOOR & HRDWR SOL.; eddiea@locknet.com; 859-432-2289

NO.	DOOR MATERIAL	SIZE	FRAME	FAC/EDGE	THK.	CORE	LITE	RATE	PASSAGE	LOCKSET	PRIVACY	S.F. PULL	S.F. PUSH	PANIC	BUTT	CONT. HAND	FLOOR	WALL	THRESHOLD	SILENCERS	KICKPLATE	CLOSER	REMARKS
(01)	EXISTING ALUMINUM STOREFRONT	3'-0" X 7'-0"	ALUM.	EXIST.	ALUM.	1 3/4"	HOLLOW	GLASS	-	●	●	●	●	●	●	●	●	●	●	●	●	●	EXISTING DOOR PULL ON EXTERIOR SIDE
(02)	EXISTING ALUMINUM STOREFRONT	3'-6" X 7'-0"	ALUM.	EXIST.	ALUM.	1 3/4"	HOLLOW	GLASS	-	●	●	●	●	●	●	●	●	●	●	●	●	●	EXISTING DOOR PULL ON EXTERIOR SIDE
(03)	S.C. WOOD	3'-0" X 7'-0"	H. MTL.	PLASTIC LAM. PRE-FINISHED	1 3/4"	SOLID	-	-	●	●	●	●	●	●	●	●	●	●	●	●	●	●	KICKPLATE ON EA. SIDE OF DOOR
(04)	S.C. WOOD	3'-0" X 7'-0"	H. MTL.	PLASTIC LAM. PRE-FINISHED	1 3/4"	SOLID	-	-	●	●	●	●	●	●	●	●	●	●	●	●	●	●	KICKPLATE ON EA. SIDE OF DOOR
(01B)	ALUM. STORE VESTIBULE	3'-0" X 7'-0"	ALUM.	MATCH EXIST. ALUM.	1 3/4"	HOLLOW	GLASS	-	●	●	●	●	●	●	●	●	●	●	●	●	●	●	

WALL SCHEDULE		INSTALLED AND FURNISHED BY G.C. UNLESS NOTED OTHERWISE	
NO.	DESCRIPTION		
(EX)	EXISTING		
(W2)	3-5/8" 20GA. METAL STUD WALL W/ 3/8" TYPE "X" GYP. BOARD BOTH SIDES (SEE ARCHITECTURAL DETAILS & ELEVATIONS)		
(W3)	3-5/8" 20GA. METAL STUD WALL W/ 3/8" TYPE "X" GYP. BOARD ON ONE SIDE (SEE ARCHITECTURAL DETAILS & ELEVATIONS)		
(W5)	6" 20GA. METAL STUD WALL W/ 3/8" TYPE "X" GYP. BOARD BOTH SIDES (SEE ARCHITECTURAL DETAILS & ELEVATIONS)		
(W6)	6" 20GA. METAL STUD WALL W/ 3/8" TYPE "X" GYP. BOARD ONE SIDE (SEE ARCHITECTURAL DETAILS & ELEVATIONS)		
(W7)	1 1/2" 20GA. HAT CHANNEL FURRING W/ 3/8" TYPE "X" GYP. BOARD ON ONE SIDE. REFER DETAILS FOR FURRING DISTANCE		

WALL PANEL SCHEDULE					INSTALLED AND FURNISHED BY G.C. UNLESS NOTED OTHERWISE				
NO	MANUFACTURER	DESCRIPTION	MFG #	COLOR FINISH	REMARK				
(WP1)	CRANE COMPOSITES INC.	F.R.P. THICKNESS: .075	LBGS.14	#636 (GRAY), S/M/S	CONTACT: LAUREN ARMSTRONG 815.467.8684				
(WP2)	-	S.S. PANEL (22 GA)	-	BRUSHED FINISH	FURNISHED BY PX, INSTALLED BY G.C.				
(WP3)	-	S.S. PANEL (22 GA)	-	DIAMOND PATTERN FINISH	FURNISHED BY PX, INSTALLED BY G.C.				
(W106)	WOLF GORDON	WALLCOVERING	-	GOLD LANTERN & CLOUD	CONTACT: CATHY DY 310.770.1165 cathy.dy@wolfgordon.com				
(W107)	WOLF GORDON	WALLCOVERING	-	FRETWORK					
(W108)	-	CANOPY GRAPHIC	-	-					
(G-4b)	-	MENU BACKER PANEL	TBD	TBD					
(W111)	-	WALL MURAL	TBD	TBD					

SPECIAL SURFACE SCHEDULE					INSTALLED AND FURNISHED BY G.C. UNLESS NOTED OTHERWISE				
NO	MANUFACTURER	PRODUCT	MFG #	STAIN / COLOR	FINISH	REMARK			
(02-3)	DALTILE	ARTIFICIAL QUARTZ	-	BROADWAY BLACK	POLISHED	SERVICE COUNTER & DRINK STATION PROVIDED BY PX, INSTALLED BY G.C.			

INTERIOR PAINT SCHEDULE					INSTALLED AND FURNISHED BY G.C. UNLESS NOTED OTHERWISE				
NO	MANUFACTURER	MFG #	COLOR	FINISH	REMARK				
(P0Aa)	SHERWIN-WILLIAMS	SW 7065	ARGOS	PROMAR 200, ZERO VOC, LATEX SEMI-GLOSS	REAR SERVICE DOOR				
(P101)	SHERWIN-WILLIAMS	SW 6252	ICE CUBE	PROMAR 200, ZERO VOC, LATEX EGG-SHELL	RESTROOM & RESTROOM VESTIBULE CEILING, DINING ROOM SOFFIT				
(P104)	SHERWIN-WILLIAMS	SW 2850	CHELSEA GRAY	PROMAR 200, ZERO VOC, LATEX EGG-SHELL	DINING RM. WALLS, RESTROOM VESTIBULE WALLS				
(P105)	NOT USED								
(P106)	SHERWIN-WILLIAMS	SW 7069	IRON ORE	DTM ACRYLIC GLOSS, LOW VOC	RESTROOM DOOR FRAMES				
(P205)	SHERWIN-WILLIAMS	SW 7069	IRON ORE	PROMAR 200, ZERO VOC, LATEX EGG-SHELL	FRONT & UNDERSIDE OF SERVICE LINE & BACK OF SERVICE LINE SOFFIT				

WALL LEGEND

	EXISTING EXTERIOR WALL
	NEW EXTERIOR WALL FRAMED WITH STRUCTURAL STEEL STUDS
	NEW INTERIOR WALL (FULL HT.)
	NEW INTERIOR WALL (LOW WALL - REF. ELEV. & DETAILS)
	WALK-IN BOX PANEL

NOTE: THE FOLLOWING STAINLESS STEEL PROVIDED BY PX-INSTALLED BY G.C.:

- PANEL DIVIDERS AT WP3
- INSIDE CORNER AT WP3 TO WP2
- FLASHING AT TOP OF BASE WP3
- WP2 PIECE AT LENGTH OF WALL

NOTE: THE FOLLOWING STAINLESS STEEL PROVIDED BY G.C.-INSTALLED BY G.C.:

- INSTALL 18 GA STAINLESS STEEL CORNER GUARD & WALL CAP INSIDE KITCHEN

	18 GA. STAINLESS STEEL CORNER GUARD - FULL HT.
	18 GA. STAINLESS STEEL CORNER GUARD - 4'-0" HIGH
	18 GA. STAINLESS STEEL CORNER GUARD/FRAME - ALL AROUND PERIMETER OF OPENING - FRAME TO BE WELDED TO FORM SINGLE UNIT.
	18 GA STAINLESS STEEL WALL CAP

ALL OTHER STAINLESS STEEL BY G.C.

NOTE!!!!!!!!!!!!!!:

***ALL INTERIOR DIMENSIONS ARE TO FACE OF GYPSUM BOARD**

NOTE:

CONTRACTOR TO NOTIFY 3rd PARTY VENDOR, PER THE VENDOR LIST, FOR WALL PRE-TREAT BEFORE CLOSING WALLS

TILE SCHEDULE (SEE SHEET A-104)

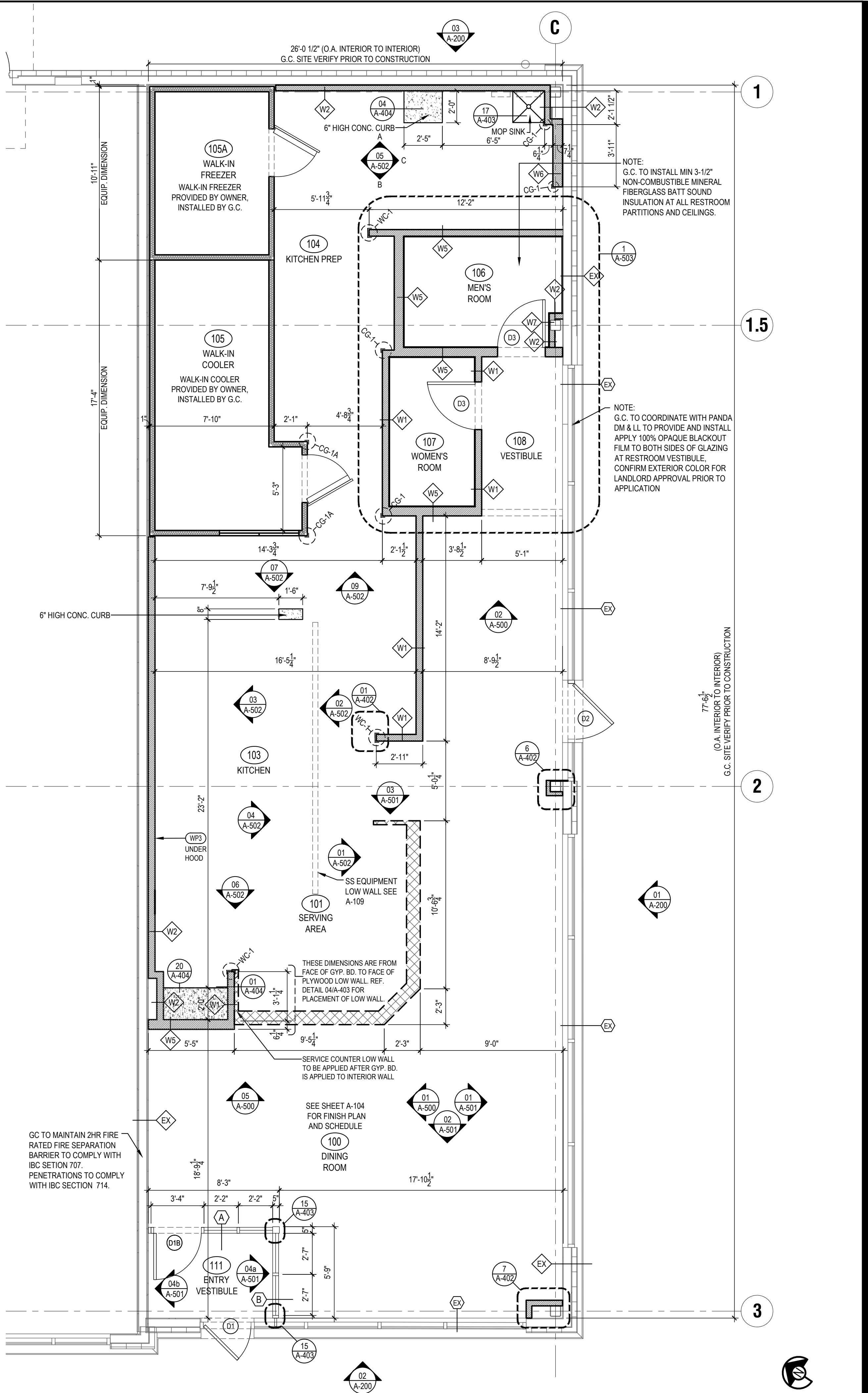

FLOOR PLAN 1

Scale= 1/4" = 1'-0" A-103



PANDA EXPRESS, INC.
1683 Walnut Grove Ave.
Rosemead, California
91770
Telephone: 626.799.9898
Facsimile: 626.372.8288

All ideas, designs, arrangement and plans indicated or represented by this drawing are the property of Panda Express Inc. and were created for use on this specific project. None of these ideas, designs, arrangements or plans may be used by or disclosed to any person, firm, or corporation without the written permission of Panda Express Inc.

REVISIONS:

MD STATE HEALTH PR 01 02/24/2023

ISSUE DATE:

LL REVIEW 12-23-22
PERMITS 12-28-22
BID/ CONSTRUCTION SET 08-11-23

DRAWN BY: AB/ TD

PANDA PROJECT #: S4-24-D6247

PANDA STORE #: D6247

ARCH PROJECT #: JCOT18-0152

I certify that these documents were prepared or approved by me, and that I am a duly licensed architect or engineer under the laws of the State of Maryland, license number _____, expiration date _____

NORR
ARCHITECTS PLANNERS PLUMBERS

PANDA EXPRESS

PANDA HOME 2600
14 CRANBROOK ROAD
Cockeysville, MD 21030

A-103

FLOOR PLAN

PANDA HOME 2600 R3

BID/CONSTRUCTION SET 08-11-2023