

# CORNER RECORD

Agency Index BK 112 PG 94  
Document Number CR 11598  
City of EDEN TOWNSHIP County of ALAMEDA, California  
Brief Legal Description RAILROAD SPIKE MONUMENT LOCATED WITHIN KNOX ST AT N. 4TH ST.

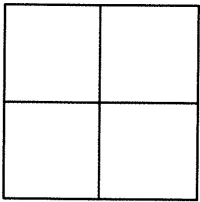

## CORNER TYPE

Government Corner ☐ Control ☒  
Meander ☐ Property ☐  
Rancho ☐ Other ☐

Date of Survey 6/11/18

## COORDINATES (Optional)

N. 2074788± E. 6104916±  
Elevation \_\_\_\_\_  
Units Metric ☐ U.S. Survey Foot ☐  
Horizontal Datum \_\_\_\_\_  
Zone \_\_\_\_\_ Epoch Date \_\_\_\_\_  
Vertical Datum \_\_\_\_\_  
☐ Complies with Public Resources Code §§8801-8819  
☐ Complies with Public Resources Code §§8890-8902

PLS Act Ref: ☐ 8765(d) ☒ 8771 ☐ 8773 ☐ Other:  
Corner/Monument: ☒ Left as found ☐ Established ☐ Rebuilt ☒ Pre-Construction  
☐ Found and tagged ☐ Reestablished ☒ Referenced ☐ Post-Construction

Narrative of corner identified and monument as found, set, reset, replaced, or removed:

☐ See sheet #2 for description(s) :

FOUND RAILROAD SPIKE BURIED 5" BELOW GRADE. EXCAVATED PRIOR TO REFERENCING.

FOUND AND SET POINTS AS SHOWN ON PAGE 2.

THIS POINT WAS REFERENCED PRIOR TO A CONSTRUCTION PROJECT IN THE VICINITY.

THE TIES SHOWN HEREON ARE FOR THE PURPOSE OF PERPETUATING FOUND MONUMENTATION.  
NO CLAIM IS MADE AS TO THE RELATIONSHIP OF THE POINTS OR LINES SHOWN HEREON TO TRUE  
BOUNDARY LOCATION.

## SURVEYOR'S STATEMENT

This Corner Record was prepared by me or under my direction in conformance with

the Professional Land Surveyors' Act on JUNE 15, 2018.

Signed SCOTT V. CUNHA P.L.S. or R.C.E. No. LS 8525

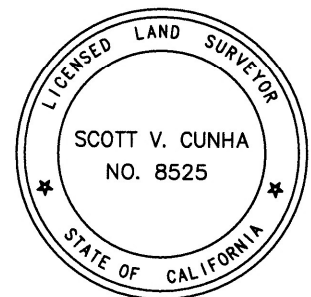

## COUNTY SURVEYOR'S STATEMENT

This Corner Record was received 19 JUNE 2018

and examined and filed 11 SEPTEMBER 2018

Signed Michael Rubner P.L.S. or R.C.E. No. 6843

Title COUNTY SURVEYOR

County Surveyor's Comment

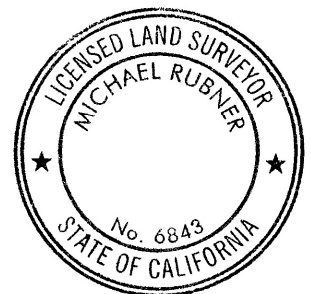

SPEC-2355-Pre

SCALE: 1"=30'

## LEGEND

△ FOUND RAILROAD SPIKE WITH PUNCH

⊗ SET CUT CROSS IN WALK

✕ SET CUT CROSS IN CURB

⊗ SET MAG AND SHINER

○ SET REBAR & CAP STAMPED "CEI RP"

AA##A# ALAMEDA COUNTY MONUMENT ID

19592 REFERENCE STREET ADDRESS

